

Original BMW Parts and Accessories. Installation Instructions.



M Performance Steering Wheel Retrofit. (F4x, G2x, G8x)

Retrofit kit number

32 30 2 462 905	M Performance steering wheel without shift paddles
32 30 2 462 906	M Performance steering wheel with shift paddles
32 30 2 462 910	M Performance steering wheel with shift paddles
32 30 5 A29 D29	M Performance rear steering wheel covers (for cars without shift paddles)

Installation time

The installation time is **approx. 0.75 hours**. This may vary depending on the condition of the car and its equipment package.

The installation time shown does not include any time spent on programming/coding.

The calculation of the total costs for the programming time must be factored into the calculation of retrofitting costs (no invoicing via warranty).

Important information

These installation instructions are primarily designed for use within the BMW dealership organisation and by authorised BMW service companies.

These installation instructions are intended for use by qualified specialist staff trained on BMW vehicles with the relevant expert knowledge.

All work must be completed using the latest BMW repair manuals, wiring diagrams, servicing manuals and work instructions, in a logical order, using the prescribed tools (special tools), and observing current health and safety regulations.

If you experience installation or functional problems, restrict troubleshooting to approx. 0.5 hours for mechanical work and 1.0 hours for electrical work.

To avoid unnecessary extra work and/or costs, please send an inquiry to the technical parts support team.

Quote the following information:

- VIN,
- retrofit kit part number,
- a detailed description of the problem,
- any work already carried out.

Please do not archive the printout of these installation instructions. The current version can be found in the EPC.

Pictograms



Denotes instructions that draw your attention to dangers.



Denotes instructions that draw your attention to special features.



Denotes the end of the instruction or other text.

Installation information

All pictures show LHD (left-hand drive) cars; proceed in the same way on RHD (right-hand drive) cars.

Some of the installation is shown only on the left-hand side of the car; proceed in the same way on the right-hand side of the car.

Ensure that the cables and/or lines are not kinked or damaged as you install them in the car. Costs arising from this will not be reimbursed by BMW AG.

Additional cables/lines that you install must be secured with cable ties.

All cables, lines and control units must be taken from the standard M sport steering wheel.

Furthermore, the ring eyelet for the ground point under the horn plate must be replaced. A new ring eyelet is supplied in the retrofit kit.

Information for the workshop

When the M Performance steering wheel is installed in cars with steering wheel heating SA 248, the heating function is lost. No decoding is required. The switch for steering wheel heating is non-functional. The error memory entry can be ignored.

To order, an M Performance Alcantara/carbon cover without switches for the steering wheel heating system can be installed. This is not included in the retrofit kit and must be ordered separately (32 30 2 463 594). In addition, the multi-function keys be installed in the new M Performance Alcantara/carbon cover as described in **ISTA/AIR**.

Special tools required

Set of crimping pliers SWZ 61 4 340 (83 30 0 496 833)

Table of contents

Section	Page
1. Preparatory work	4
2. Parts list	5
3. Installation	6
4. Concluding work and coding	9

1. Preparatory work

	ISTA No./AIR No.
Conduct a brief test	---
Disconnect the negative battery cable	61 20 900
The following components must be removed first of all	
Airbag unit	32 33 020
M sport steering wheel	32 33 020
Shift paddles (if applicable)	32 33 020
M decor trim	32 33 020
Horn plate	32 33 020
Vibration actor (if applicable)	32 33 020
Wiring harness with all control units	32 33 020

2. Parts list

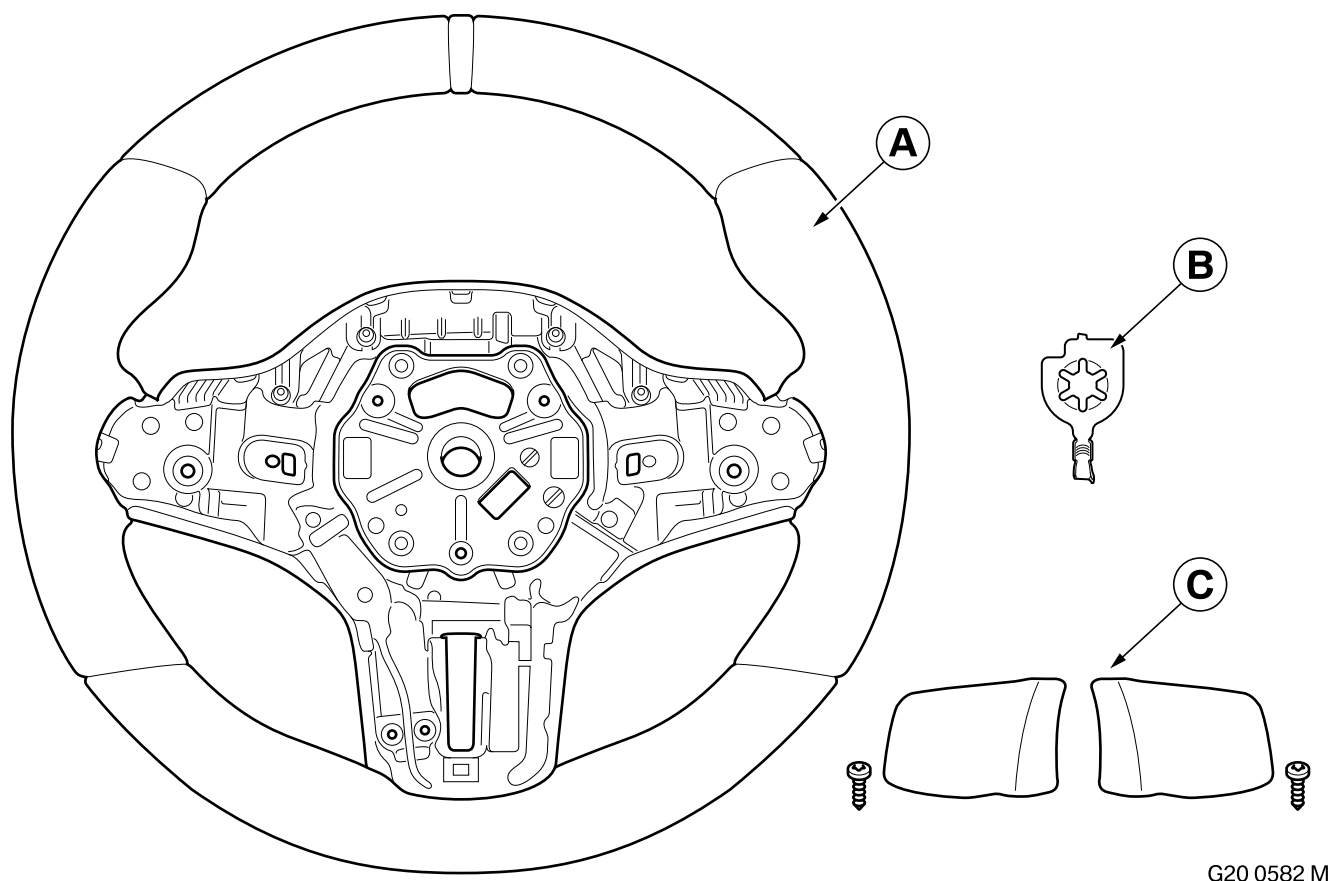

Legend

- A** M Performance steering wheel
- B** Ring eyelet (1 x)
- C** Covers with screws

3. Installation

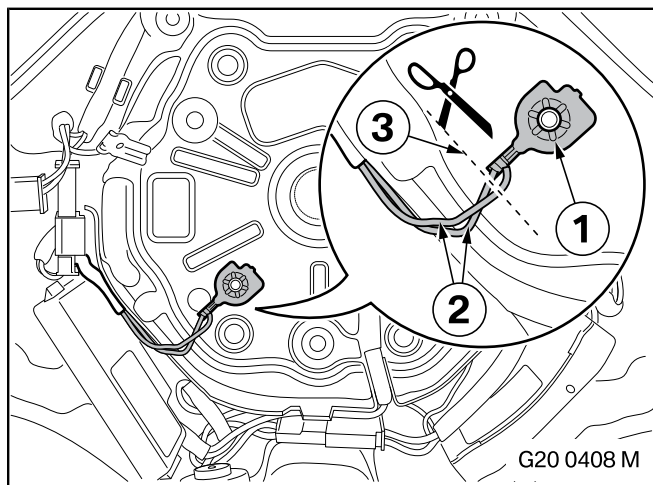

Remove the airbag unit, M Sport steering wheel, shift paddles (if applicable), M Sport buttons on the left and right (if applicable), M Sport decor trim horn plate, vibration actor (if applicable) and steering wheel wiring harness with all the control units as described in **ISTA/AIR**.

- ▶ After removal, the ring eyelet (1) will be defective and must not be reused. ◀
- ▶ Contrary to the repair instructions for the M Sport steering wheel in **ISTA/AIR**, reuse the standard steering wheel wiring harness and simply replace the ring eyelet (1). See the following description for further details. ◀

⚠ If the cables (2) are cut too short, the complete steering wheel wiring harness must be replaced. ◀

Cut both cables (2) as shown here right at the end of the installation crimp (3).

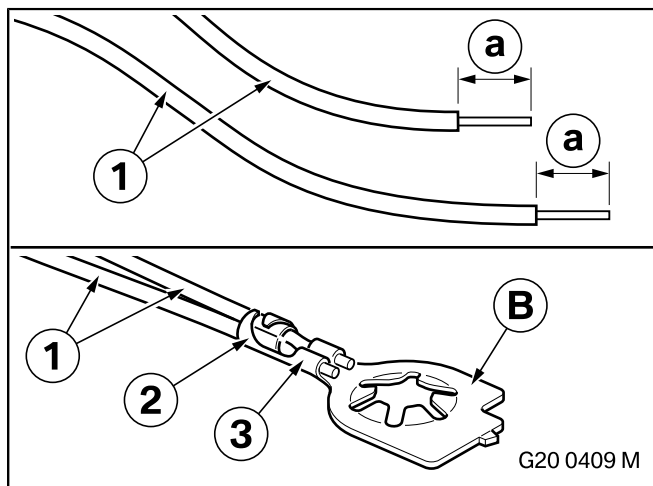

- ▶ Repair instructions 61 11 ... Refer to the instructions for cutting, stripping and crimping cables.

The special tool (SWZ 61 4 340) must be used to ensure correct crimping. To prevent consequential damage, the crimping must be completed very carefully. ◀

Strip both cables (1) approx. 4 mm (a) from the standard steering wheel wiring harness.

Crimp the ring eyelet **B** to both cables (1) using the special tool (SWZ 61 4 340). Ensure that the insulation crimps (2) and wire crimps (3) are correctly positioned.

Correct crimping

The cable ends (1) and installation ends (2) are visible.

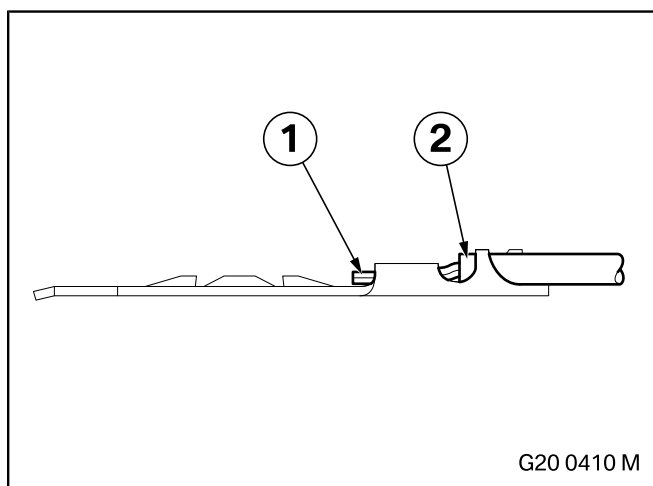

3. Installation

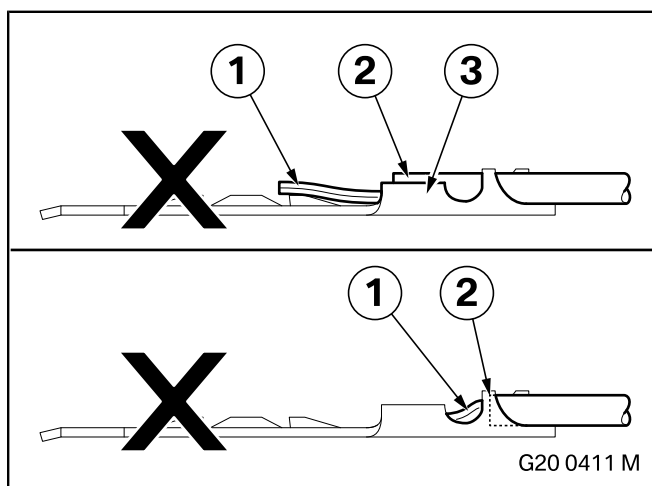

Incorrect crimping

The cable ends (1) are too deeply embedded and the insulation ends (2) are in the wire crimp (3).

The cable ends (1) and installation ends (2) are not visible.

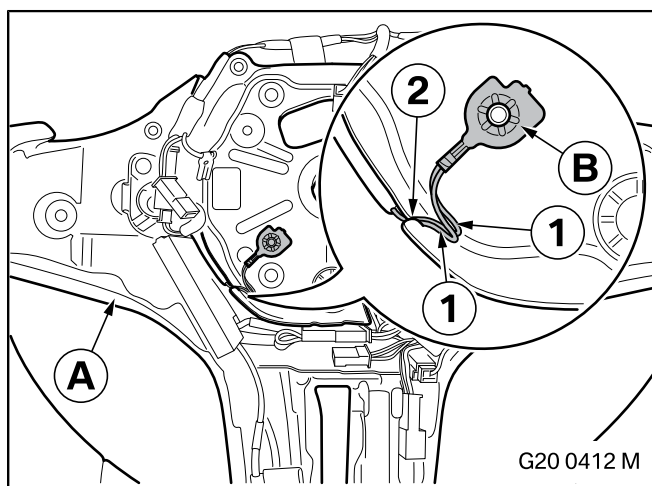

Install the standard steering wheel wiring harness with all the control units and replaced ring eyelet **B** in exactly the same way in the M Performance steering wheel **A**.

Ensure that the cables (1) are fully inserted in the recess (2).

After installing the horn plate, it must be impossible for contact to be made between the cables (2) and the horn plate.

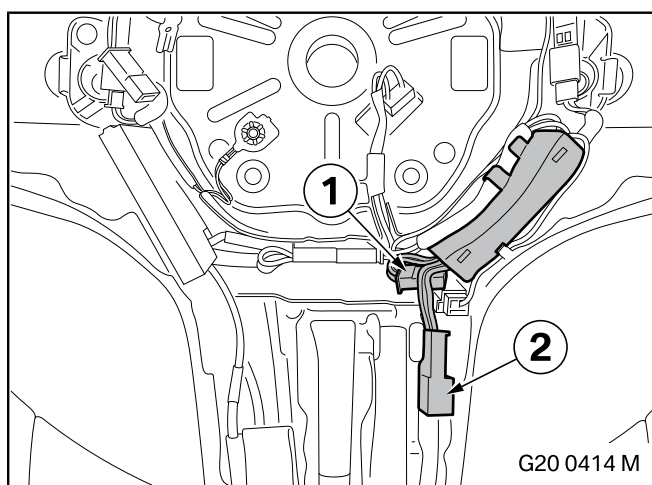

For cars with steering wheel heating (SA 248):

▶ If the M Performance Alcantara/carbon cover (32 30 2 463 594) is installed, the switch for the steering wheel heating is not required.

If the standard M decor trim is installed, the steering wheel heating switch is non-functional.
The error memory entry can be ignored. ◀

Disconnect the switch for the steering wheel heating (SA 248) from the standard steering wheel wiring harness.

Route plugs (1) and (2) as shown here.

Ensure that the plug (1) is inserted firmly below the plug (2).

3. Installation

For all cars:

Install the horn plate, vibration actor (if applicable), standard M decor trim or M Performance Alcantara/carbon cover (32 30 2 463 594), shift paddles (if applicable), M Sport buttons on the left and right (if applicable), M Performance steering wheel **A** and airbag unit as described in **ISTA/AIR**.

For cars without shift paddles (G8x):

Insert the rear steering wheel covers (32 30 5 A29 D29) into the openings for the shift paddles on the rear left and right of the steering wheel and secure them using the screws supplied in the kit.

Tightening torque 2 Nm.

4. Concluding work and coding

The retrofit system does not require programming/coding.

- Re-assemble the car
- Connect the battery
- Conduct a function test